

HP-PVC PIPE & FITTINGS

HP-PVC Pipe <CLASS VP:JIS K6741>

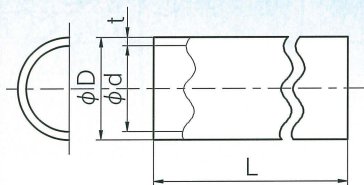

Working Pressure with Temperature

MPa {kgf/cm²}

Nom. Size	Temp.			
	20°C	30°C	40°C	50°C
13mm - 300mm	1.0{10.2}	0.9{9.2}	0.7{7.1}	0.3{3.1}

Note: This data is applicable for ultrapure water.

●HP-PVC Pipe <CLASS VP:JIS K6741> Unit:mm

Nominal Size (mm)	D			t		d	L
	Outer diameter			Wall Thickness			
	Basic Dimension (mm)	Maximum and Minimum tolerances	Average tolerances	Minimum	Tolerance		
13	18	±0.2	±0.2	2.2	+0.6	13	4,000±10
16	22	±0.2	±0.2	2.7	+0.6	16	4,000±10
20	26	±0.2	±0.2	2.7	+0.6	20	4,000±10
25	32	±0.2	±0.2	3.1	+0.8	25	4,000±10
30	38	±0.3	±0.2	3.1	+0.8	31	4,000±10
40	48	±0.3	±0.2	3.0	+0.8	40	4,000±10
50	60	±0.4	±0.2	4.1	+0.8	51	4,000±10
65	76	±0.5	±0.3	4.1	+0.8	67	4,000±10
75	89	±0.5	±0.3	5.5	+0.8	77	4,000±10
100	114	±0.6	±0.4	6.6	+1.0	100	4,000±10
125	140	±0.8	±0.5	7.0	+1.0	125	4,000±10
150	165	±1.0	±0.5	8.9	+1.4	146	4,000±10
200	216	±1.3	±0.7	10.3	+1.4	194	4,000±10
250	267	±1.6	±0.9	12.7	+1.8	240	4,000±10
300	318	±1.9	±1.0	15.1	±2.2	286	4,000±10

(Note)

- The tolerances of lengths are ± 10mm.
- The maximum and minimum tolerances on outside diameters are the tolerances on O.D. measurements taken at randomly selected spots.
- The average tolerances on outside diameters are the tolerances on the arithmetical mean of O.D. measurements taken at randomly selected spots in two directions at a right angle to each other.

Dimensions Common All of AV TS Socket. JIS K6743

▼13mm - 150mm

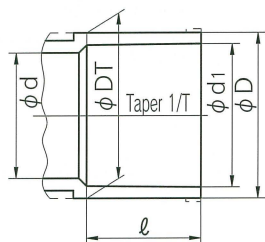

▼200mm - 250mm

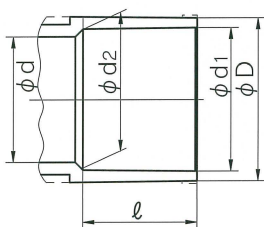

Working Pressure with Temperature

MPa {kgf/cm²}

Nom. Size	Temp.			
	20°C	30°C	40°C	50°C
13mm - 150mm	1.0{10.2}	0.9{9.2}	0.7{7.1}	0.3 {3.1}
200mm	0.75 {7.7}	0.6{6.1}	0.5{5.1}	0.25{2.6}
250mm	0.6{6.1}	0.5{5.1}	0.4{4.1}	0.2{2.0}

Note: This data is applicable for ultrapure water.

●Dimensions Common All of AV TS Socket. JIS K6743 Unit:mm

Nominal Size (mm)	d ₁	Tolerance on d ₁	d ₂	ℓ	1/T	D	DT	Tolerance on D&DT	d (minimum value)	Pipe O.D.
13	18.40	±0.20	-	26	1/30	24	24.0	-0.6	13	18
16	22.40	±0.20	-	30	1/34	29	29.0	-0.7	16	22
20	26.45	±0.20	-	35	1/34	33	33.0	-0.8	20	26
25	32.55	±0.25	-	40	1/34	40	40.0	-1.0	25	32
30	38.60	±0.25	-	44	1/34	46	46.0	-1.0	31	38
40	48.70	±0.30	-	55	1/37	57	57.0	-1.2	40	48
50	60.80	±0.30	-	63	1/37	70	70.0	-1.5	51	60
※ 65	76.60	±0.30	-	61	1/48	87	88.5	-1.5	67	76
75	89.60	±0.30	-	64	1/49	102	104.5	-1.5	77	89
100	114.70	±0.30	-	84	1/56	130	133.5	-1.8	100	114
※125	140.85	±0.35	-	104	1/58	157	161.0	-1.8	125	140
150	166.00	±0.40	-	132	1/63	186	190.0	-2.0	146	165
※200	217.00	-	214.10	145	-	240	-	-	194	216
※250	288.20	-	265.00	155	-	295	-	-	247	267

(Note)

- The tolerances on ℓ are +4/-0.5mm.
- The Nominal Size marked with ※ conform to the AV standard and the JPPFA standard.

Fittings in size 200, 250mm are available on request by FRP reinforcement.
 Max working pressure
 200mm : 1.0MPa{10.2kgf/cm²} at 20°C
 250mm : 1.0MPa{10.2kgf/cm²} at 20°C

Elbow(L)



▼13mm - 50mm

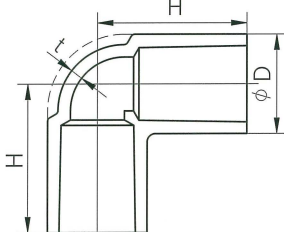

▼65mm - 250mm

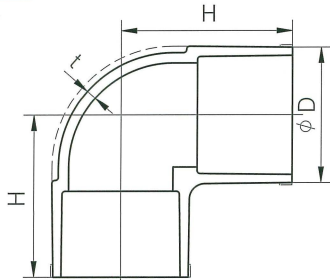

●Elbow(L) Unit:mm

Nominal Size (mm)	D	t	H
13	24	3.0	36
16	29	3.5	43
20	33	3.5	50
25	40	4.0	58
30	46	4.0	65
40	57	4.5	82
50	70	5.0	96
※ 65	87	6.6	110
※ 75	102	8.0	120
※ 100	130	10.0	153
※ 125	157	11.0	188
※ 150	186	13.0	230
□ 200	240	15	265
□ 250	295	16	310

(Note)

- The tolerances on H are +5/-1mm.
- The Nominal Size marked with ※ conform to the JPPFA standard.
- The Nominal Size marked with □ conform to the AV standard.

HP-PVC PIPE & FITTINGS

90° AV Bend

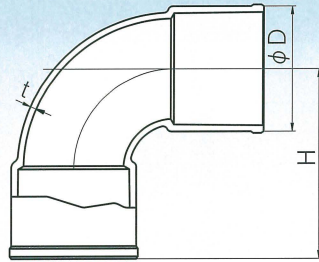

●90° AV Bend

Unit:mm

Nominal Size(mm)	D	t	H
□ 200	240	15	341
□ 250	293	16	402

(Note)

1.The Nominal Size marked with □ conform to the AV standard.

45° Elbow(45L)

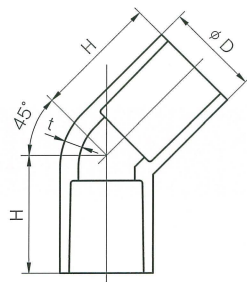

●45° Elbow(45L)

Unit:mm

Nominal Size(mm)	D	t	H
20	33	3.5	44
25	40	4.0	51

45° AV Bend

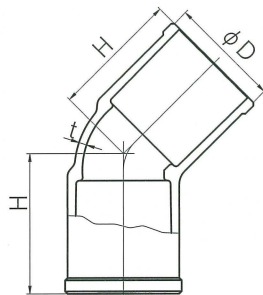

●45° AV Bend

Unit:mm

Nominal Size(mm)	D	t	H
40	57	4.5	69
50	70	5.0	80
65	87	6.0	81
□ 75	101	6.6	97
□ 100	129	7.3	122
□ 125	156	7.7	149
□ 150	185	10.0	184
□ 200	240	15	193
□ 250	293	16	213

(Note)

1.The Nominal Size marked with □ conform to the AV standard.

HP-PVC FITTINGS

Socket(S)

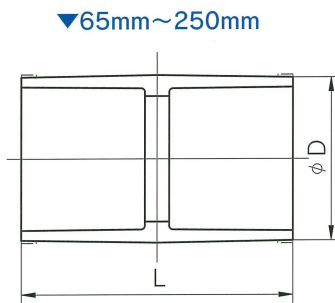
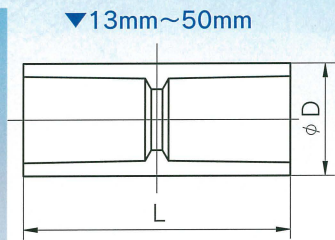
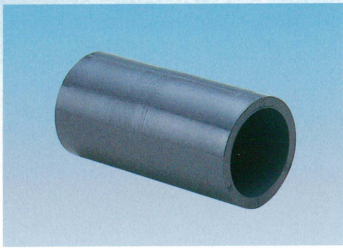

●Socket(S)			Unit:mm
Nominal Size (mm)	D	L	
13	24	57	
16	29	67	
20	33	77	
25	40	87	
30	46	95	
40	57	117	
50	70	133	
※ 65	87	145	
75	102	155	
100	130	200	
※ 125	157	240	
150	186	300	
□ 200	235	300	
□ 250	295	353	

(Note)
 1.The tolerances on L are ±4mm.
 2.The Nominal Size marked with ※ conform to the JPPFA standard.
 3.The Nominal Size marked with □ conform to the AV standard.

Reducing Socket(RS)

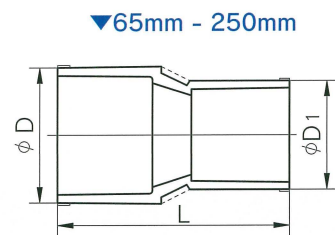
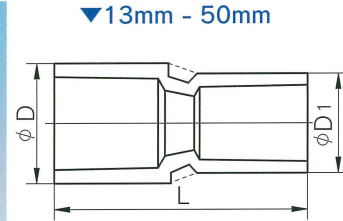

●Reducing Socket(RS)				Unit:mm
Nominal Size (mm)	D	D1	L	
20×13	33	24	68	
20×16	33	29	71	
25×13	40	24	86	
25×16	40	29	85	
25×20	40	33	84	
○ 30×13	48.2	28.2	73.2	
○ 30×20	48.2	36.2	83	
30×25	46	40	93	
※ 40×20	57	33	113	
40×25	57	40	114	
40×30	57	46	114	
※ 50×20	70	33	116	
※ 50×25	70	40	140	
50×40	70	57	136	
※ 65×50	87	70	149	
75×50	102	70	165	
※ 75×65	102	87	159	
100×75	130	102	190	
※ 125×100	157	130	229	
※ 150×125	186	157	272	
□ 200×150	240	186	356	
□ 250×200	293	240	383	

(Note)
 1.The tolerances on L are ±4.0mm.
 2.The Nominal Size marked with ※ conform to the JPPFA standard.
 3.The Nominal Size marked with □ conform to the AV standard.
 4.○ There sizes are not in accordance with JISK 6743 and therefore welding arrangement is not available.

HP-PVC FITTINGS

Tee(T)



▼13mm - 50mm

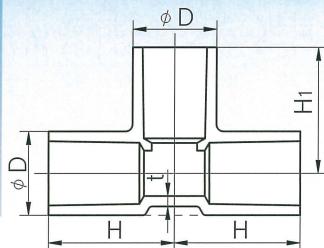

▼65mm - 250mm

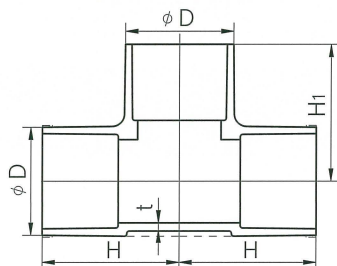

●Tee(T) Unit:mm

Nominal Size (mm)	D	t	H	H ₁
13	24	3.0	36	36
16	29	3.5	43	43
20	33	3.5	50	50
25	40	4.0	58	58
30	46	4.0	65	65
40	57	4.5	82	82
50	70	5.0	96	96
※ 65	87	6.6	110	110
75	102	8.0	120	120
100	130	10.0	152	152
※ 125	157	11.0	187	187
150	186	13.0	230	230
□ 200	240	15	266	266
□ 250	295	16	331	331

(Note)
 1. The tolerances on H are +5/-1mm.
 2. The Nominal Size marked with ※ conform to the JPPFA standard.
 3. The Nominal Size marked with □ conform to the AV standard.

Reducing Tee(RT)



▼13mm - 50mm

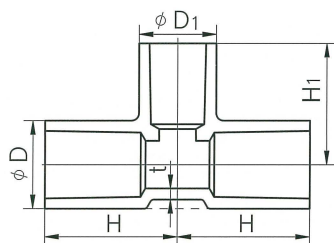

▼65mm - 250mm

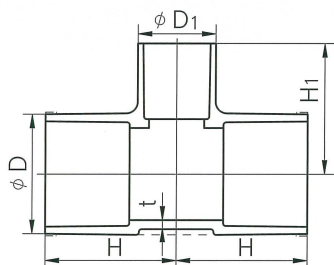

●Reducing Tee(RT) Unit:mm

Nominal Size (mm)	D	t	H	D ₁	H ₁
16× 13	29	3.5	41	24	38
20× 13	33	3.5	46	24	40
20× 16	33	3.5	48	29	45
25× 13	40	4.0	51	24	43
25× 16	40	4.0	53	29	48
25× 20	40	4.0	55	33	53
○30× 13	48.2	6.5	54.7	28.2	44
30× 16	46	4.0	57	29	51
30× 20	46	4.0	59	33	56
30× 25	46	4.0	62	40	61
40× 13	57	4.5	66	24	52
○40× 16	58.4	5.2	62.4	30.9	52.5
40× 20	57	4.5	70	33	62
40× 25	57	4.5	73	40	67
40× 30	57	4.5	76	46	71
50× 13	70	5.0	74	24	58
50× 16	70	5.0	76	29	63
50× 20	70	5.0	78	33	68
50× 25	70	5.0	81	40	73
50× 30	70	5.0	84	46	77
50× 40	70	5.0	90	57	88
※ 65× 40	87	6.6	100	57	95
※ 65× 50	87	6.6	101	70	104
75× 25	102	8.0	93	40	88
75× 40	102	8.0	100	57	102
75× 50	102	8.0	105	70	110
100× 50	130	10.0	125	70	122
100× 75	130	10.0	140	102	132
※ 125× 75	157	11.0	160	102	147
※ 125× 100	157	11.0	173	130	167
150× 75	186	13.0	195	102	158
150× 100	186	13.0	208	130	182
※ 150× 125	186	13.0	217	157	201
□ 200× 75	240	15	201	102	180
□ 200× 100	240	15	215	130	200
□ 200× 150	240	15	238	188	253
□ 250× 75	295	16	226	108	210
□ 250× 100	295	16	246	136	225
□ 250× 200	295	16	304	245	310

(Note)
 1. The tolerances on H are +5/-1mm.
 2. The Nominal Size marked with ※ conform to the JPPFA standard.
 3. The Nominal Size marked with □ conform to the AV standard.
 4. ○ There sizes are not in accordance with JISK 6743 and therefore welding arrangement is not available.

HP-PVC FITTINGS

Faucet Elbow(FL)

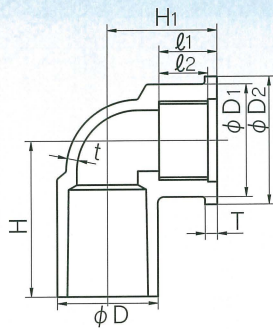

● Faucet Elbow(FL)

Unit:mm

Nominal Size (mm)	D	t	D ₁	D ₂	l ₁	l ₂	T	H	H ₁ S形	Nominal size of female threads
□ 13	24	3.0	30	34	17	14	4	38	29	Rp1/2
□ 16	29	3.5	30	34	17	14	4	43	32	Rp1/2
□ 20	33	3.5	37	42	19	16	4	51	36	Rp3/4
□ 25	40	4.0	46	52	21	18	5	59	40	Rp1

(Note)

- The threaded portions employ parallel female threads specified in JIS B 0203(Taper Pipe Threads).
- The tolerances on H are +5/-2mm.
- The tolerances on H₁ are +5/-2mm.
- The Nominal Size marked with □ conform to the AV standard.
- The tolerances on l₂ are ± 1mm.

Precautions in use

- when connecting threaded portions, use both sealing tape and gaskets jointly.
- Do not use HP-PVC Faucet Elbows to connect steel pipes and PVC pipes.
- Secure the elbows with fixtures.

Valve Socket(VS)

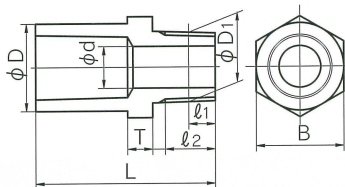

● Valve Socket(VS)

Unit:mm

Nominal Size (mm)	D	d	O.D. of basic form D ₁	Number of threads per inch	Location of basic diameter l ₁	l ₂ (Minimum)	T	L	B
13×1/2	24	13	20.955	14	8.16	13.16	6	50	24
16×1/2	29	13	20.955	14	8.20	15	6	54	29
20×3/4	33	18	26.441	14	9.53	14.53	8	64	33
25×1	40	23	33.249	11	10.39	16.79	8	71	40
30×1 1/4	46	31	41.910	11	12.70	19.10	10	80	46
40×1 1/2	57	37	47.803	11	12.70	19.10	10	92	57
50×2	70	48	59.614	11	15.88	23.38	12	106	70
□ 65×2 1/2	87	62	75.184	11	17.46	26	14	118	87
□ 75×3	102	72	87.884	11	20.64	30	16	128	102
□ 100×4	130	96	113.030	11	25.40	36	18	157	130

(Note)

- The threaded portions employ parallel female threads specified in JIS B 0203(Taper Pipe Threads).
- The tolerances on L are +5/-2mm.
- The Nominal Size marked with ※ conform to the JPPFA standard.
- The Nominal Size marked with □ conform to the AV standard.

Precautions in use

- Do not repeat screw-in and removal.
- when connecting threaded portions, use sealing tape.

Faucet Socket(FS)

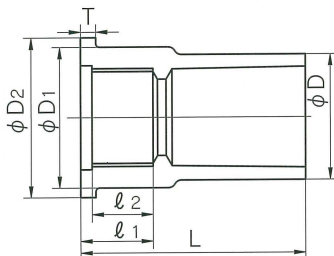
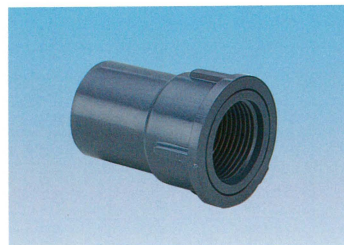

● Faucet Socket(FS)

Unit:mm

Nominal Size (mm)	D	D ₁	D ₂	l ₁	l ₂	T	L	Nominal size of female threads
□ 13	24	30	34	17	14	4	47	Rp1/2
□ 16	29	30	34	17	24	4	52	Rp1/2
□ 20	33	37	42	19	16	4	59	Rp3/4
□ 25	40	46	52	21	18	5	68	Rp1

(Note)

- The threaded portions employ parallel female threads specified in JIS B 0203(Taper Pipe Threads).
- The tolerances on L are +5/-1mm.
- The tolerances on l₂ are ± 1mm.
- The Nominal Size marked with □ conform to the AV standard.

Precautions in use

- when connecting threaded portions, use both sealing tape and gaskets jointly.
- Do not use HP-PVC Faucet Elbows to connect steel pipes and PVC pipes.
- Secure the elbows with fixtures.

Cap(C)



▼ 13mm - 50mm

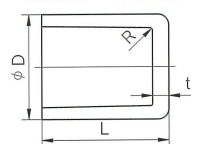

▼ 65mm - 100mm

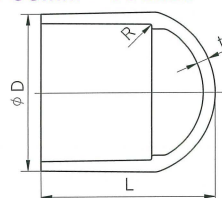

● Cap(C)

Unit:mm

Nominal Size (mm)	D	t	L
13	24	3.0	29.0
16	29	3.5	33.5
20	33	3.5	38.5
25	40	4.0	44.0
40	57	4.5	59.5
50	70	5.0	68.0
※ 65	87	6.6	96.0
75	102	8.0	105.0
100	130	10.0	138.0

(Note)

- The tolerances on L are +5/-20mm.
- The Nominal Size marked with ※ conform to the JPPFA standard.
- R is 1 to 5mm