

# Rotary Damper Type 57,56 (Electric Actuated Type T) 40mm - 400mm(1½inch - 16inch) Type57:40-350mm(1½inch-14inch),Type56:400mm(16inch)

## Body Material

PVC  
PP  
PVDF

## O-ring Material

EPDM  
FKM

## Connection Standard

JIS 10K · JIS 5K  
ANSI CLASS150  
DIN PN10

## Power Source

Single-Phase  
AC100V/110V/200V/220V

## Equipment

Space Heater  
Output Contact Limit Switches  
Indicator  
Manual Operation-Mechanism

## Option

E-E Positioner  
Intermediate Limit Switch (no-volt)  
Speedcontrol Unit

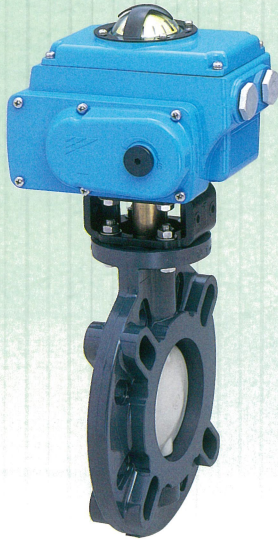

## FEATURES

- Damper Style is Designed for Flow Control.(Damper Style is not a tight off Valve.)
- Lightweight and Compact with High-Torque.
- Manual Operation Handle is equipped normally and operativeness has improved.
- Indicator that can be seen easily.

## OPTIONAL EQUIPMENT

Combination No.	1	2	3	4	5	6	7
Space Heater	●	●	○	●	○	●	○
Output Contact Limit Switches	●	●	●	—	●	—	●
Potentiometer	—	○	—	—	—	○	○
E-E Positioner	—	—	○	—	—	—	—
Intermediate Limit Switch (no-volt)	—	—	—	○	—	○	—
Speedcontrol Unit	—	—	—	—	○	—	○

●Standard Equipment

## ACTUATOR SPECIFICATION

Nominal Size mm(inch)	40-150(1½inch-6inch)	200-350(8inch-14inch)	400(16inch)
Actuator Type	AOC-0	AOC-2	AOC-3
Cycle Time 50/60Hz(seconds)	25/20		55/50
Motor Output(W)	8		90
Motor Starting Current(A) 50/60Hz	100V	1.20/1.20	5.1/4.8
	110V	1.40/1.40	6.1/6.6
	200V	0.50/0.50	2.6/2.4
	220V	0.70/0.70	3.1/3.0
Motor Rated Current(A) 50/60Hz	100V	0.50/0.50	1.6/1.7
	110V	0.60/0.60	1.7/1.8
	200V	0.25/0.25	0.8/1.0
	220V	0.30/0.30	0.9/1.0
Number of revolutions of manual operating handle	6.7	16.5	16.5
Limit Switch Capacity	AC 250V 10A		
Protective Structure	JIS C 0920 Waterjet-proof type (IEC IP65)		
Cable Connector Nominal Size	G1/2		
Motor Pole(P)	4		
Motor Insulation	E Class		
Motor Time Rating(minute)	30		
Space Heater Output(W)	5		

## WORKING PRESSURE VS. TEMPERATURE

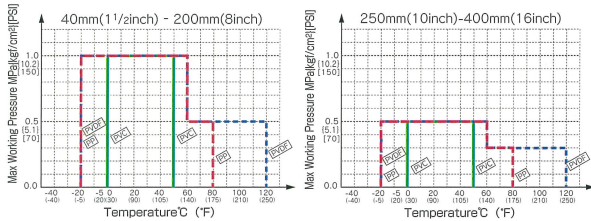

## DIMENSIONS FIGURE

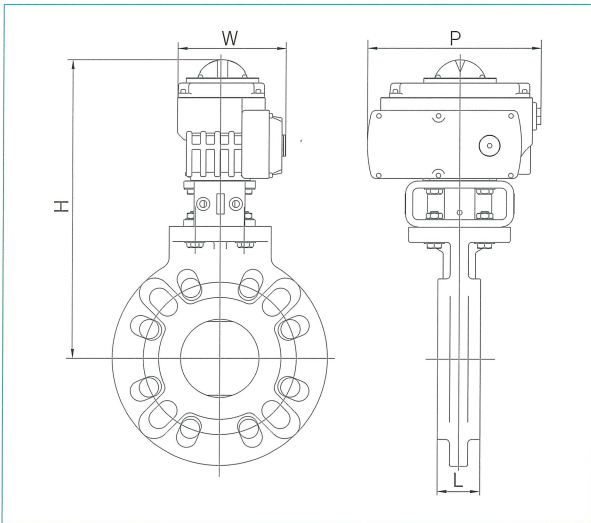

## SCHEMATIC DIAGRAM

### WIRING DIAGRAM

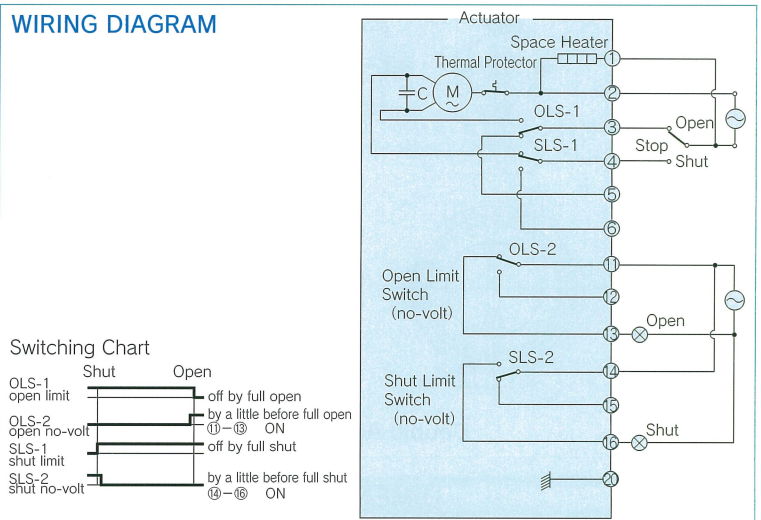

## DIMENSIONS TABLE

JIS, ANSI, DIN												Unit:mm(inch)
Nominal Size	40 (1½)	50 (2)	65 (2½)	80 (3)	100 (4)	125 (5)	150 (6)	200 (8)	250 (10)	300 (12)	350 (14)	400 (16)
L	32 (1.26)	35 (1.38)	37 (1.46)	37 (1.46)	47 (1.85)	57 (2.24)	62 (2.44)	76 (2.99)	96 (3.78)	116 (4.57)	116 (4.57)	157 (6.12)
	290 (11.42)	300 (11.81)	310 (12.20)	325 (12.80)	340 (13.39)	361 (14.21)	376 (14.80)	455 (17.91)	490 (19.29)	566 (22.28)	593 (23.37)	650 (25.35)
H	310 (12.20)	320 (12.60)	330 (12.99)	345 (13.58)	360 (14.17)	381 (15.00)	396 (15.59)	475 (18.70)	510 (20.08)	586 (23.07)	613 (24.13)	670 (26.13)
	138.8 (5.47)	138.8 (5.47)	138.8 (5.47)	138.8 (5.47)	138.8 (5.47)	138.8 (5.47)	138.8 (5.47)	239 (9.42)	239 (9.42)	239 (9.42)	239 (9.42)	381.5 (14.88)
W	202 (7.96)	202 (7.96)	202 (7.96)	202 (7.96)	202 (7.96)	202 (7.96)	202 (7.96)	310 (12.20)	310 (12.20)	310 (12.20)	310 (12.20)	388 (15.13)
P	202 (7.96)	202 (7.96)	202 (7.96)	202 (7.96)	202 (7.96)	202 (7.96)	202 (7.96)	310 (12.20)	310 (12.20)	310 (12.20)	310 (12.20)	388 (15.13)